



### Key Features

- **High expandability**

Up to 20 Door Stations, 32 IP cameras and 5 Room Monitors can be connected.

- **PoE support**

The Door Station and Room Monitor support PoE (IEEE 802.3af compliant, class 2 device). A power supply unit is also available (VL-PS240 is sold separately).

- **Card reader**

The Door Station has an RFID reader that can be used to unlock the electric lock. Up to 10,000 cards can be recorded.

- **Electric lock release support\***

The electric lock can be easily and quickly released from the Room Monitors and the card reader on the Door Stations. \*Optional relay box (VL-RLY1) is required.

- **Picture recording / FTP uploading\*\*** \*\* Consult Panasonic for FTP server setting.

Up to 100 images can be recorded to the Room Monitor. Images can also be automatically uploaded to an FTP server when a visitor calls from a Door Station.

- **7-inch touch screen**

The Room Monitor has a 7-inch wide LCD that clearly shows each visitor's face, and the touch screen provides an easy-to-use operation screen.

- **High-resolution camera, Night Vision with LED lights :**

The Door Station has a 1.3 M pixel camera that provides a clear image with a wide view of 113° (horizontal), 69° (vertical). You can check visitors even when it's dark outside.

### Maximum System Configuration

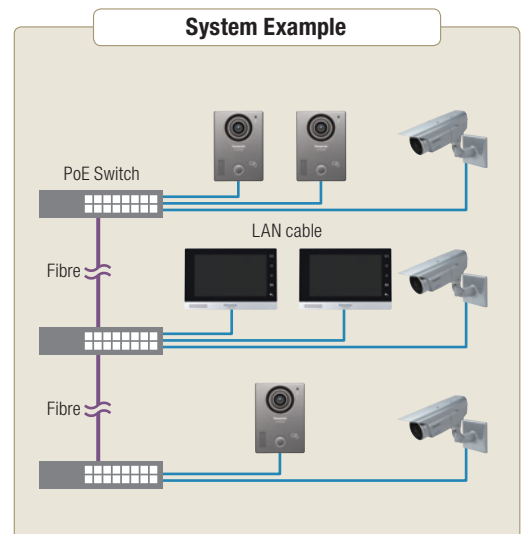
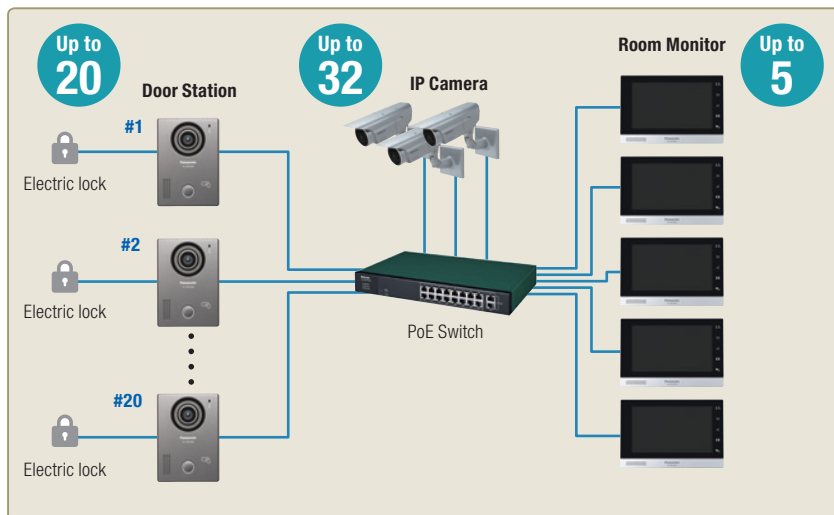

### Wiring Schematic Diagram

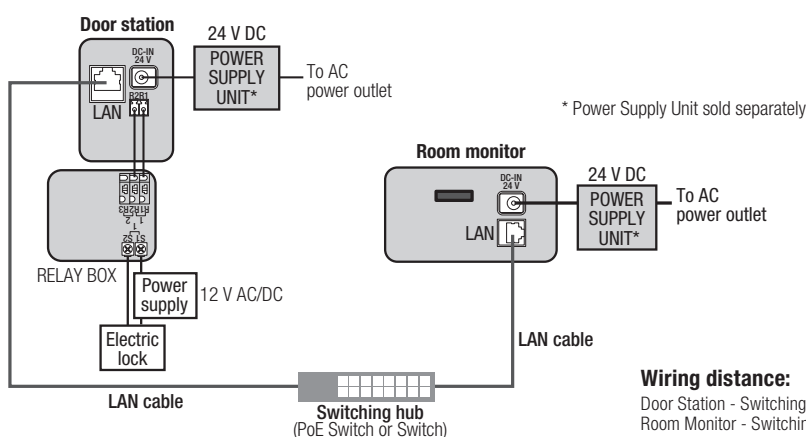

### IP Camera Integration

- **Operation Specification**

- Codec Format: H.264 (Fixed)
- Image Resolution: 720p (1280x720 pixels) or less
- Frame Rate: 20 fps or less

- **Recommended Models**

- E-series
- iPRO

The Installation Guide is available at the following web site.

<https://panasonic.net/cns/pcc/support/intercom/mn1000/>

\* The system setup/configuration shall be made by the installer.

#### Wiring distance:

Door Station - Switching hub: Up to 100 m (UTP Cat5e or higher)

Room Monitor - Switching hub: Up to 100 m (UTP Cat5e or higher)

# Specifications

Model number	VL-VN1500 (Door Station)	VL-MN1000 (Room Monitor)	VL-PS240 (Power Supply Unit)	VL-RLY1 (Relay Box)
Dimensions (Unit: mm)				
Power source	PoE (IEEE 802.3af compliant, Class 2 device) or Power supply unit (VL-PS240*) 24 V DC, 0.6 A	PoE (IEEE 802.3af compliant, Class 2 device) or Power supply unit (VL-PS240*) 24 V DC, 0.6 A	Input: 220-240 V AC, 0.2 A (50/60 Hz) Output: 24 V DC, 0.6 A	Supplied by the door station
Power consumption	PoE: Standby: 2.5 W, Operating: 5.1 W VL-PS240: Standby: 2.6 W, Operating: 6.3 W	PoE: Standby: 1.9 W, Operating: 6.3 W VL-PS240: Standby: 2.1 W, Operating: 6.2 W	-	-
Dimensions (H x W x D) (Excluding protruding sections)	141 x 100 x 28.5 mm	137.5 x 205 x 27.8 mm	116 x 100 x 54 mm	92 x 78 x 38 mm
Weight	250 g	550 g	230 g	130 g
Operating environment	Ambient temperature: Approx. -10 °C to +55 °C Relative humidity (non-condensing): up to 90 %	Ambient temperature: Approx. 0 °C to +40 °C Relative humidity (non-condensing): up to 90 %	Ambient temperature: Approx. 0 °C to +50 °C Relative humidity (non-condensing): up to 90 % (indoor use only)	Ambient temperature: Approx. 0 °C to +40 °C Relative humidity (non-condensing): up to 90 %
Display	-	7-inch wide colour display with touch screen (800x480 pixels)	-	-
Display language	-	English, Arabic, French, Italian, German, Spanish and Dutch	-	-
Talking method	Hands-free	Hands-free	-	-
Network interface	10BASE-T/100BASE-TX (Auto MDI/MDI-X)	10BASE-T/100BASE-TX (Auto MDI/MDI-X)	-	-
Network protocol	TCP/IP, UDP	TCP/IP, UDP	-	-
Wiring	UTP (cat.5e or higher)	UTP (cat.5e or higher)	-	-
Card reader (RFID)	13.56 MHz (ISO/IEC 14443 Type A (MIFARE))	-	-	-
Expanded interface	E-lock x 1 *Relay box VL-RLY1 is required (sold separately)	Sensor input x 5 (including emergency / urgency button)	-	-
Viewing angle	Horizontally: Approx. 113°, Vertically: Approx. 69°	-	-	-
Image sensor	1.3 M pixel CMOS sensor	-	-	-
Minimum illuminance required	1 lx (within approx. 50 cm from the camera lens)	-	-	-
Lighting method	White coloured LED lights	-	-	-
Video / Audio format	Video: H.264, Audio: G.711	Video: H.264, Audio: G.711	-	-
Recording	-	Internal memory (video with audio can be saved)	-	-
IP rating / IK rating	IP54 <sup>2</sup> / -	-	-	-
Installation method	Surface mount (mounting base supplied)	Surface mount (mounting bracket supplied) or Flush mount (mounting box VL-VN1790 sold separately)	Wall mount or attach to DIN rail	Wall mount or attach to DIN rail
External material	PC+ABS resin	PC+ABS resin	Flame retardant PC+ABS resin	Flame retardant ABS resin

\*1 VL-PS240 is sold separately.

\*2 Water resistance is only assured if the Door Station is installed correctly according to the instructions in the Installation Guide, and appropriate water protection measures are taken.

## Installing the Door Station

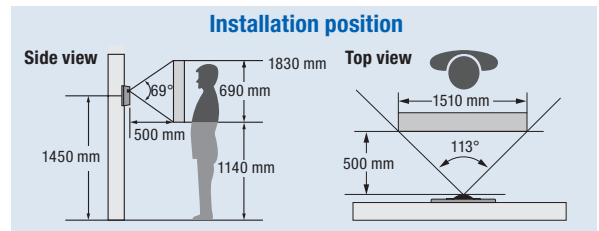
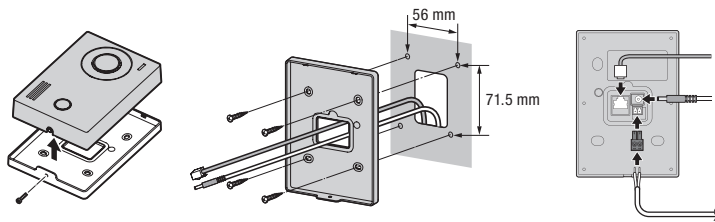

## Installing the Room Monitor

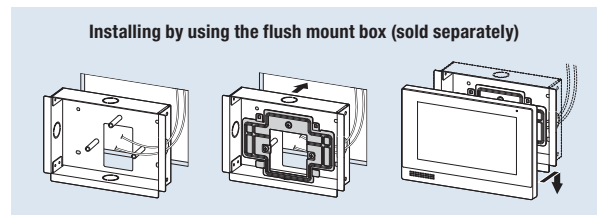
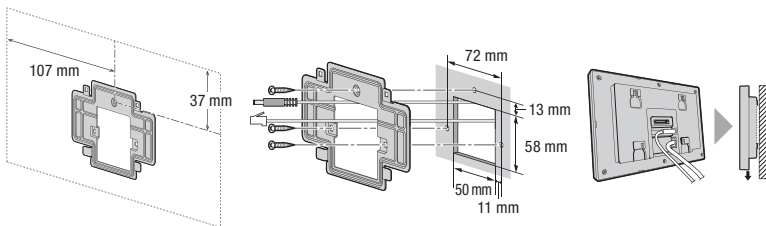

## Installing the Power Supply Unit

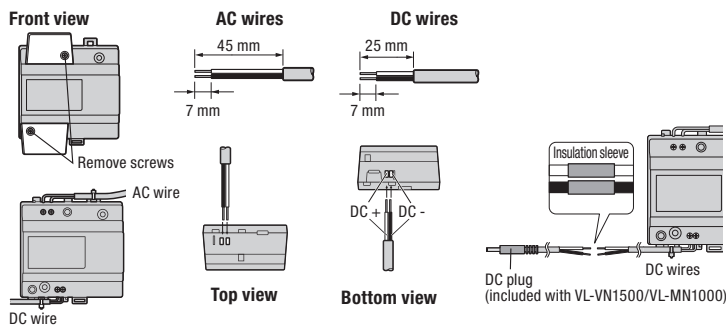

### Important

- Safety Precaution: carefully read the operating instructions and installation manual before using this product.
- Panasonic cannot be responsible for the performance of the network and/or other manufactures' products used on the network.

## Installing the relay Box

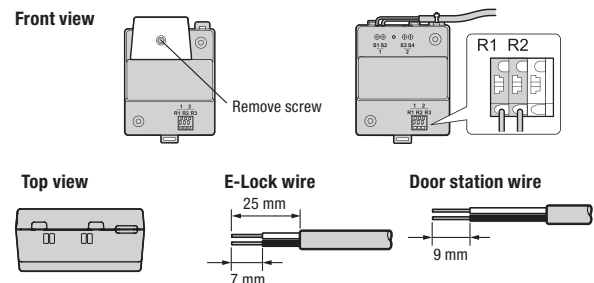

- The actual product may vary slightly from photograph.
- Weights and dimensions are approximate.
- Design and Specifications are subject to change without notice.
- These products may be subject to export control regulations.

DISTRIBUTED BY :

**Panasonic**<sup>®</sup>